



Radars Indoor

24 V LED Circuit Board



*Efficient illumination
of light boxes with a
minimum depth of 40 mm*

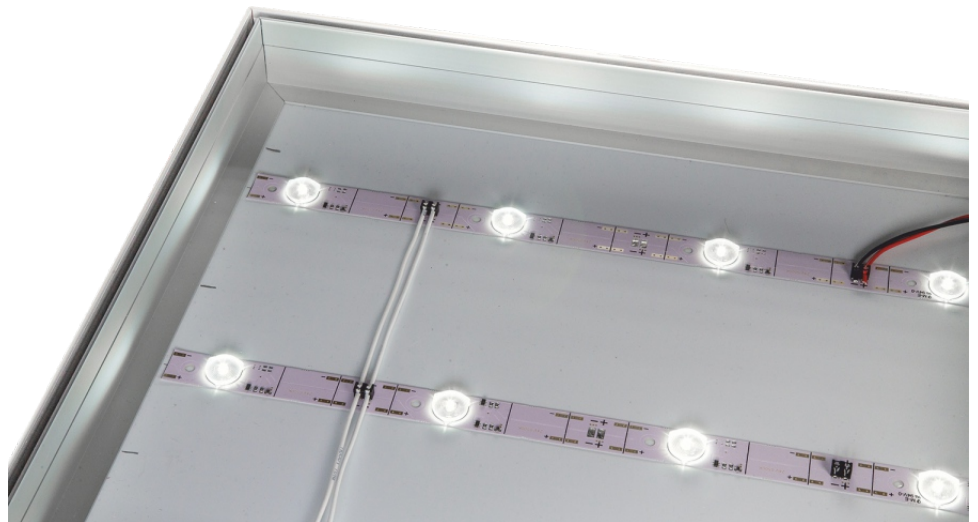

Can be cut from the roll after each LED
Quick and easy installation
Up to 12 m maximum run length



hansen
technologie · elektronik · licht

Quick and easy installation

Installing LED circuit boards into flat light boxes has never been so easy. The **Radar Indoor** LED strip can be cut from the roll to the desired length (separable after each LED) and fixed inside the box using the double-sided adhesive tape on the back of the strip. The cables are connected by means of insulation displacement connectors. The maximum run length per power supply is 12 m.

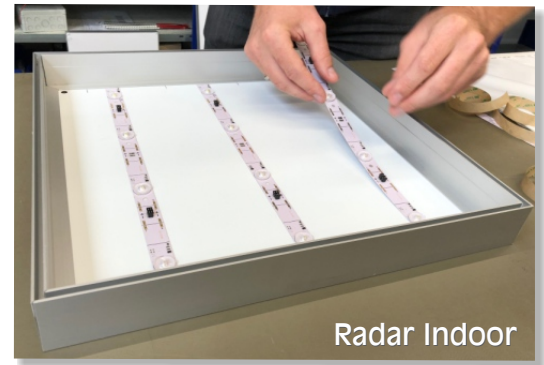

Radar Indoor

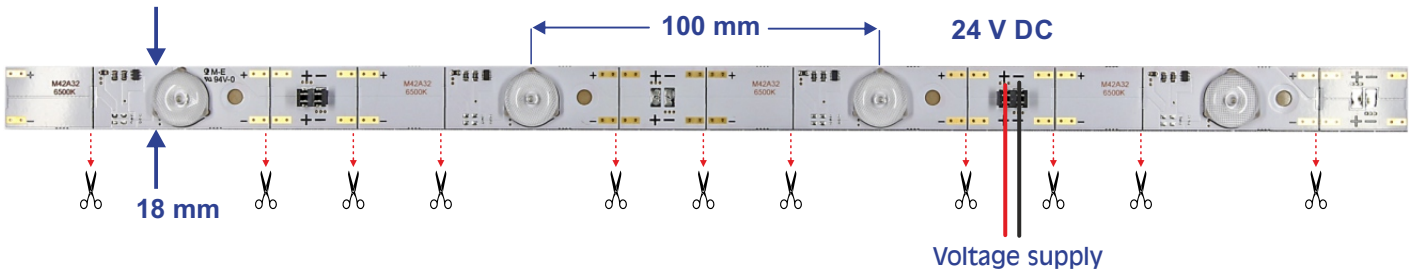

hansen Radar Indoor features

- Very large radiation angle of 170°
- Homogeneous illumination
- No soldering required for installation
- Available in custom lengths or on 12 m rolls
- Suitable power supplies and accessories available from stock
- Luminous flux: 1,210 lm/m at 5,000 K
- Colour temperatures: 3,000 K | 4,000 K | 5,000 K | 6,500 K
- 24 volts technology

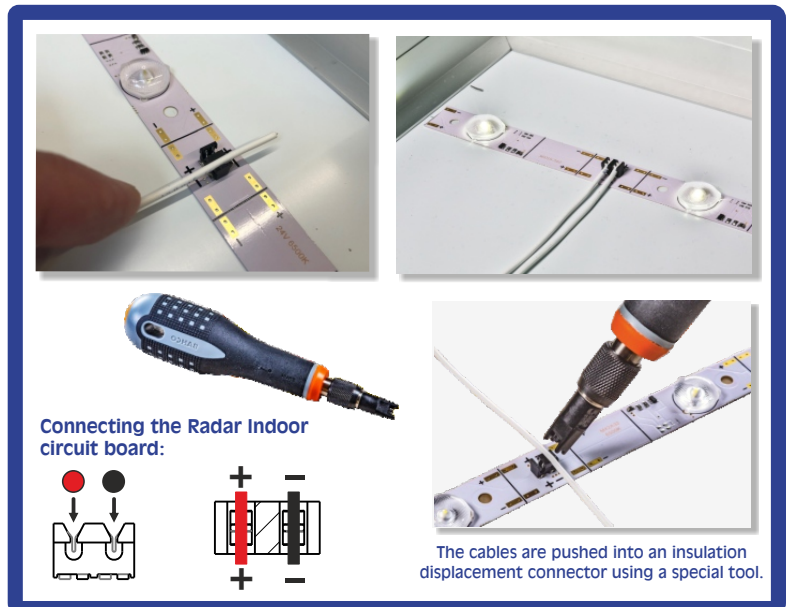

Connecting the Radar Indoor circuit board:

The cables are pushed into an insulation displacement connector using a special tool.

CE IP 00



Typische Anwendungsbeispiele

Ideal for the illumination of flat boxes with an overall depth of 40 mm and more for indoor installation. Perfect for shops, art galleries, museums, display windows and exhibition stand design.