

Description

RGB/RGBW Control

The **radio remote controls for RGB/RGBW** can be used to animate various coloured lighting applications.

Prerequisite for coloured light is the use of circuit boards equipped with RGB-LEDs. These LEDs are capable of generating 16 million colours. However, it is difficult to generate good white light using RGB-LEDs. To overcome this, RGB circuit boards can be equipped with an additional white LED capable of generating high-quality white light. Mixing both white and coloured LED light will generate pastel-coloured light.

The following products can be supplied with RGB light:

- **LED circuit boards with different dimensions**
- **Luminous Panels**
- **LED Pipe**
- **LED Mini Profiles**

The **radio remote controls** work for both RGB and RGBW, offering the following functions:

- Manual adjustment of the light colours
- Mixing of the three primary colours red, green and blue
- Manual mixing of RGB and white
- Dimming of RGB and white light
- 10 pre-set automatic programs
- Splitting of the LEDs in zones
- Storage function for customer-defined mixed light colours

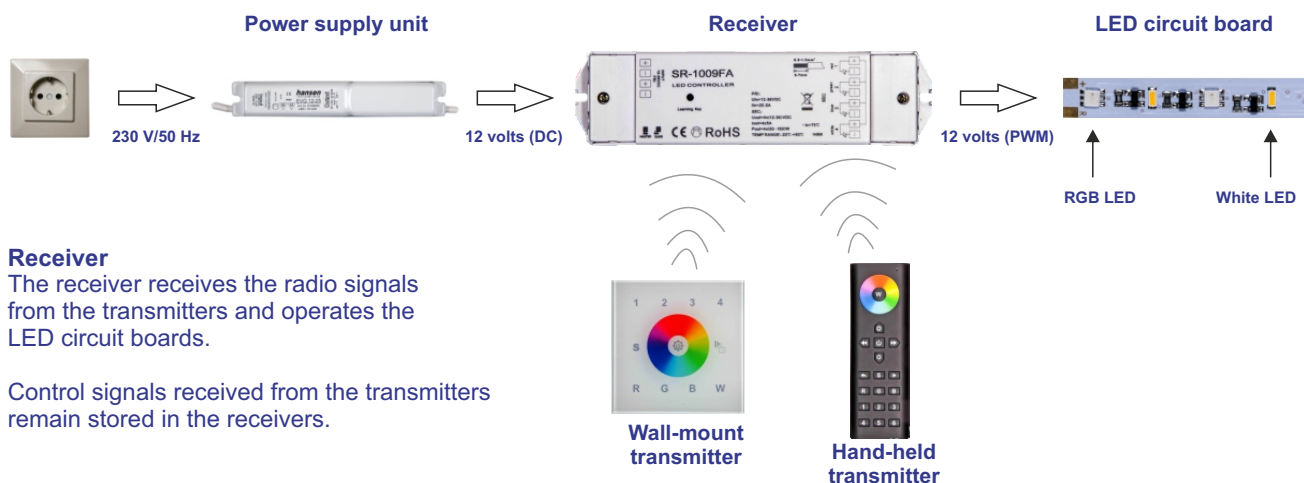

Arrangement of devices for RGB/RGBW control



Receiver

The receiver receives the radio signals from the transmitters and operates the LED circuit boards.

Control signals received from the transmitters remain stored in the receivers.

R = Red 
 G = Green 
 B = Blue 
 W = White 